

**EXPANDED AREA OF DOWNTOWN MOOSE JAW**

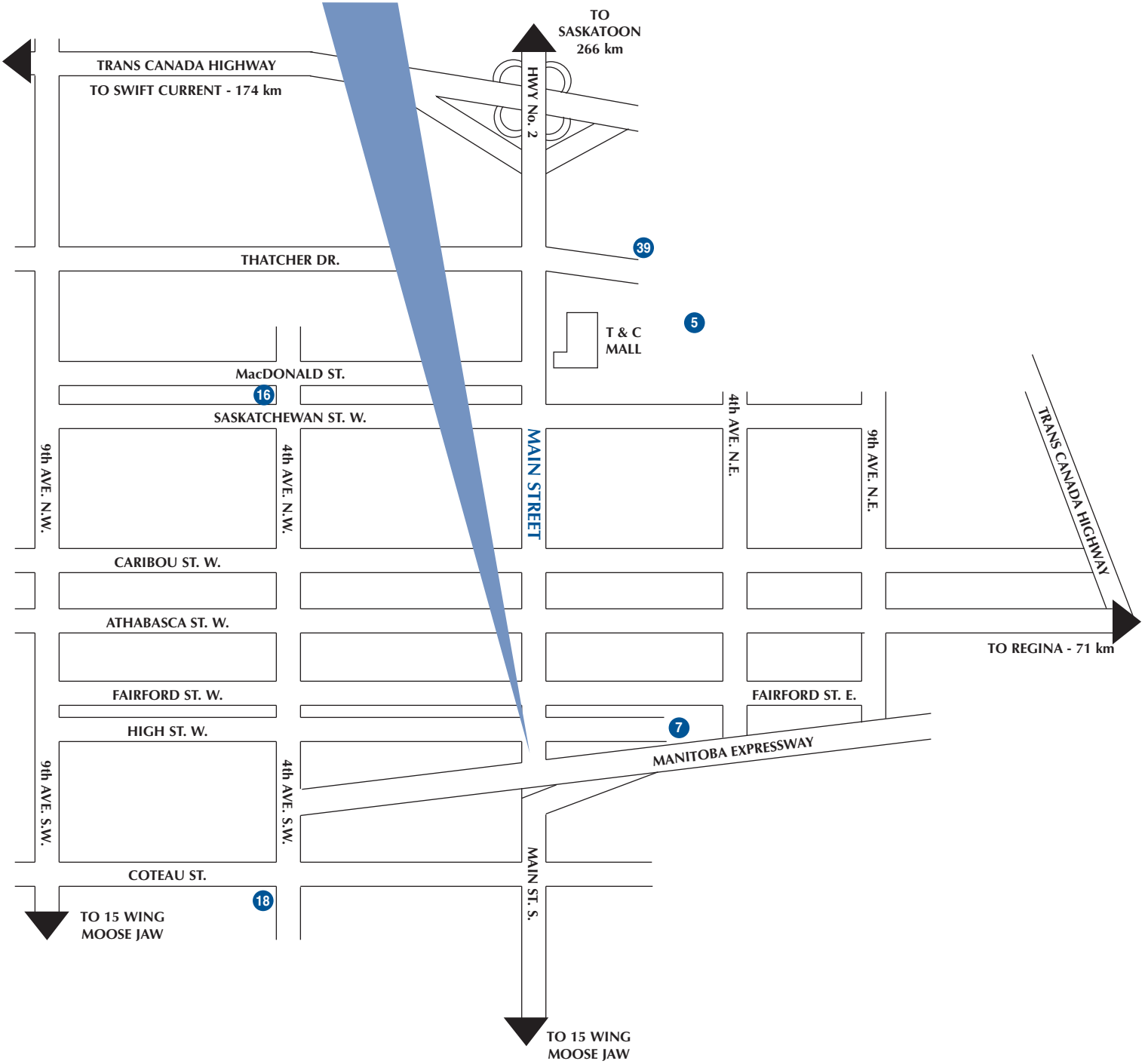
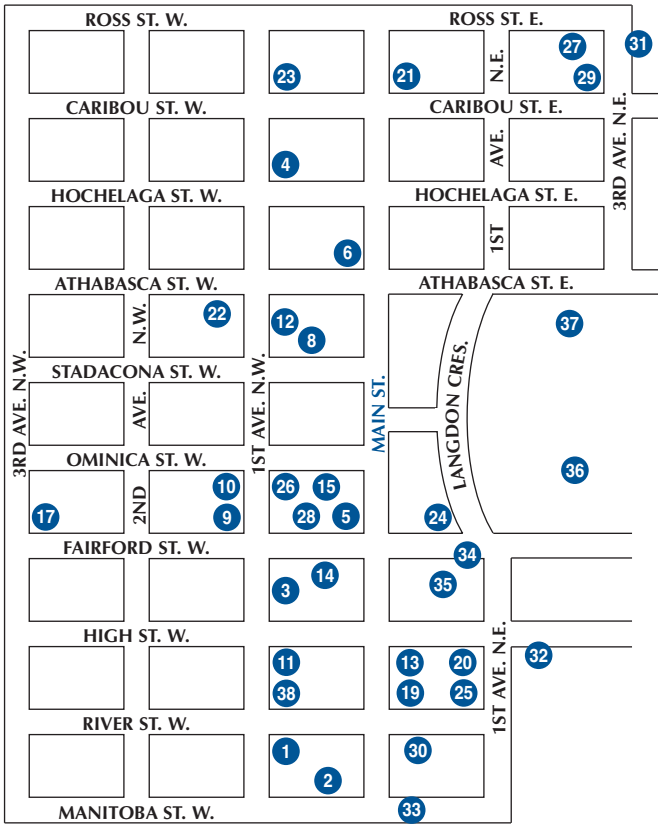

1. REMEMBER OLD 80

**69 River St. W.** - West Wall - 42' x 96'

By **Dan Sawatzky**, Chemainus, BC 1990

Dedicated to the history of the railroad's contribution to the growth of Moose Jaw.

2. OPENING DAY PARADE

**82 Manitoba St. W.** - East Wall - 16' x 50'

By **Gus Froese**, Moose Jaw, SK 1990

The opening day parade of the 1910 baseball season from railway station up to Main Street.

3. BREAKING NEW GROUND

**80 High St. W.** - North Wall - 16' x 40'

By **Paul Geraghty**, Avonlea, SK 1990

Representing the pioneer's hopes of a golden future by "proving his land" 5 acres per year for 5 years to obtain title of ownership.

4. SUNDAY SCHOOL

**60 Hochelaga St. W.** - 22' x 24'

By **Marsha Wade Charlebois**, Welland, ON 1991

This mural pays tribute to Eva Hasell and Winifred Tricehurst who did missionary work in the district in the 1920's.

5. STORMIN' MAIN STREET - 1883

**44 Fairford St. W.** - East Wall - 18' x 80'

By **Dale Cline**, Moose Jaw, SK 1991

An awesome perspective of Main Street looking north, just as a prairie storm is on the way.

6. THE LADY AND THE COW

**602 Main St. N.** - West Wall - 28' x 29'

By **Ernie Bereti**, McLean, SK 1991

For pioneer women on the prairies a cow was a prized possession. The lady is Mrs. Elizabeth Elliot.

7. MOOSE JAW UNION HOSPITAL MURAL

**455 Fairford St. E.** - Inside - 10' x 24'

By **Gus Froese**, Moose Jaw, SK 1991

This mural shows the history of the Moose Jaw Union Hospital.

8. A TRIBUTE TO LEWIS RICE

**70 Stadacona St. W.** - 13' x 16'

By **Garth Winn**, Moose Jaw, SK 1991

A tribute to a turn of the century photographer who left a rich store of historical photos.

9. TOWNS AFIRE!

**100 Fairford St. W.** - East Wall - 16' x 125'

By **Gus Froese**, Moose Jaw, SK 1991

This mural shows the fire-fighting equipment & fire hall of 1910.

10. SUNDAY OUTING

**105 Ominica St. W.** - East Wall - 8' x 16'

By **Wee Lee**, Regina, SK 1991

A delicately painted view of an engagement party boating on the Moose Jaw River.

11. RIVER STREET RED

**81 High St. W.** - West Wall - 16' x 50'

By **Brian Romagnoli**, Lincoln, ON 1991

A bold mural showing River Street in its heyday in 1920.

12. ALL IN A DAYS WORK

**80 Stadacona St. W.** - West Wall - 16' x 48'

By **Stefan Csiszar**, Santa Fe, NM, USA 1991

This unique art form depicts three successful businesses of early Moose Jaw.

13. THE FIRST RUN

**125 Main St. N.** - North Wall - 18' x 25'

By **Brian Volke**, Regina, SK 1991

On August 19, 1911, Moose Jaw's Streetcar took its first run.

14. HOPES AND DREAMS

**21 Fairford St. W.** - West Wall - 12' x 18'

By **Grant McLaughlin**, Moose Jaw, SK 1991

This Bas-relief shows a pioneer wagon loaded with all they need to homestead circa 1882.

15. SUNKA HANSA

**55 Ominica St. W.** - 18' x 24'

By **Dennis Morrison**, Ochapawace, SK 1992

A shaman of Sitting Bull's band who came to Moose Jaw after the Little Big Horn and stayed until his death in 1971.

16. THE SISTERS OF SION

**1236 - 3rd Ave. N.W.** - North Wall - 16' x 40'

By **Ernie Bereti**, McLean, SK 1992

Celebrating the centennial of the founding order, the mural is an open-book format.

17. LEST WE FORGET

**268 High St. W.** - 11' x 54'

By **Dale Cline**, Moose Jaw, SK 1992

Sponsored by the Royal Canadian Legion, this mural is dedicated to the men and women who fought in World War One and Two and beyond.

18. OUR UKRAINIAN HERITAGE

**510 - 4th Ave. S.W.** - 12' x 40'

By **Jo-Anne Dusel**, Moose Jaw, SK 1992

A centennial mural marking the 100th year of Ukrainian residence in Canada.

19. OLD TYME THRESHING BEE

**32 River St. E.** - 11' x 63'

By **Paul Geraghty**, Avonlea, SK 1992

A tribute to the farmers who made the prairies the bread basket of the world.

20. WINTER CARNIVAL

**35 High St. E.** - 16' x 34'

By **Grant McLaughlin**, Moose Jaw, SK. 1992

This mural shows winter carnival events which were popular during the long prairie winters.

21. NATIONAL LIGHT & POWER CO.

**821 Main St. N.** - 11' x 54'

By **Gus Froese**, Moose Jaw, SK 1993

This mural, sponsored by the Moose Jaw Asphalt Co., depicts the change that electric lights made to the community.

22. MARCH TO THE PIPES FOREVER

**500 - 1st Ave. N.W. - North Wall** - 12' x 24'

By **Gus Froese**, Moose Jaw, SK.

Originally painted 1993 moved to new location in 2002

A tribute to the Sprigs O' Heather All Girls Pipe Band and the Heather Highlanders Dancers.

23. DRIVING THROUGH THE YEARS

**80 Caribou St. W. - West Wall** - 6' x 21'

By **Nikki Howell** and **Bobbi Romanuk**, Moose Jaw, SK 1994

This ceramic tile mosaic depicts the history of the CAA Saskatchewan Motor Club from 1905 to present.

24. TEMPLE GARDENS 1921

**24 Fairford St. E. - Inside Spa** - 5' x 10'

By **Violet Bechtold, Jo-Anne Dusel, Dale Cline** Moose Jaw, SK. 1994

This mural of a popular local nightspot was made from about 9000 pieces of broken china.

25. AIRFORCE BLUE

**112 - 1st Ave. N.E. - West Wall** - 16' x 42'

By **Dale Cline**, Moose Jaw, SK 1994

Sponsored by 15 Wing Moose Jaw and members of Course 9401. It is a tribute to the training of pilots at the base since 1940 to date.

26. DISCOVERY

**83 Ominica St. W.** - 6' x 20'

By **Rob Froese**, Moose Jaw, SK 1994

Sponsored by SaskTel, it consists of 750 handmade clay tiles, depicting images of advancements in communication.

27. PEACOCK PRESENTS

**145 Ross St. E.**

By **Grant McLaughlin**, Moose Jaw, SK 1994

A Bas-relief of Peacock Collegiate aspects - academics, art, drama, choral and sports.

28. SUMMER GAMES

**44 Fairford St. W. - West Wall** - 10' x 80'

By **Gus Froese**, Moose Jaw, SK 1996

This mural shows the sports played at the Saskatchewan Summer Games from 1976 to 1996.

29. THE JEWELS AND THE ROYALS

**145 Ross St. E. - East Wall**

By **Central Art - Kelly Fresen, Grant McLaughlin, Pat Martin**, Moose Jaw, SK 1996

A tribute to the excellent women's baseball teams in Moose Jaw in the 30's, 40's and 50's.

30. CLARKE BROS. CIRCA 1902

**37 Main St. N. - West Wall** - 10' x 10'

By **Ruth Hamilton**, Moose Jaw, SK 1999

This mural shows the artist's father and uncle's interior of their store operated from 1902 - 1950.

31. ROSS WELLS TRIBUTE TO BASEBALL

**Ross Wells Diamond - Southeast Wall** - 16' x 48'

By **Gus Froese**, Moose Jaw, SK 1999

A tribute to the long history of world class baseball played in Moose Jaw over the years.

32. TRIBUTE TO VICTORIA SCHOOL

**175 - 1st Ave. N.E. - North Wall** - 10' x 25'

By **Jo-Anne Dusel**, Moose Jaw, SK 2000

Whimsical look at Victoria School on opening day, featuring long-time teacher Faye Baker.

33. HISTORY CPR STATION

**5 Manitoba St. E. - Free-Standing Wall**

- 12.5' x 34'

Design by **Dale Cline**, Moose Jaw, SK 1999

Painted in 2000 by his students in tribute to Dale who passed away in 1999.

34. DANCING ON RIVER STREET

**21 Fairford St. E. - North Wall** - 10' x 18'

By **Brian Romagnoli**, Lincoln, ON 2002

This mural offers a romantic retrospective glimpse of the exciting night life of River Street in the 1920's.

35. TRIBUTE TO THE AGE OF THEATRE

**21 Fairford St. E. - West Wall** - 10' x 18'

By **Brian Romagnoli**, Lincoln, ON 2002

This mural celebrates the theatres that made Moose Jaw the cultural centre of southern Saskatchewan in the 1920's.

36. FAMILY GATHERING

**Crescent Park - Serpentine**

By **Wei Luan**, Edmonton, AB 2002

A lifesize bronzed sculpture of a family of Moose gathering under the shade of an Elm tree.

37. CENTENNIAL MURAL

**Crescent Park Band Shell**

By **Grant McLaughlin**, Moose Jaw, SK 2003

A pictorial History of Moose Jaw on the Band Shell in Crescent Park from 1902 - 2003.

38. INCORPORATION OF THE CITY OF MOOSE JAW NOV 1903

**82 River St. W. - East Wall**

By **Grant McLaughlin**, Moose Jaw, SK 2003

Showing the festivities that happened in the city when the incorporation papers were signed in the Brunswick Hotel.

39. HISTORY OF MOOSE JAW EXHIBITION COMPANY

**250 Thatcher Dr. - South Wall**

By **Grant McLaughlin**, Moose Jaw, SK 2004

Shows the many facets of the Exhibition over the years.